

THE KINGSWOOD GAME TABLE

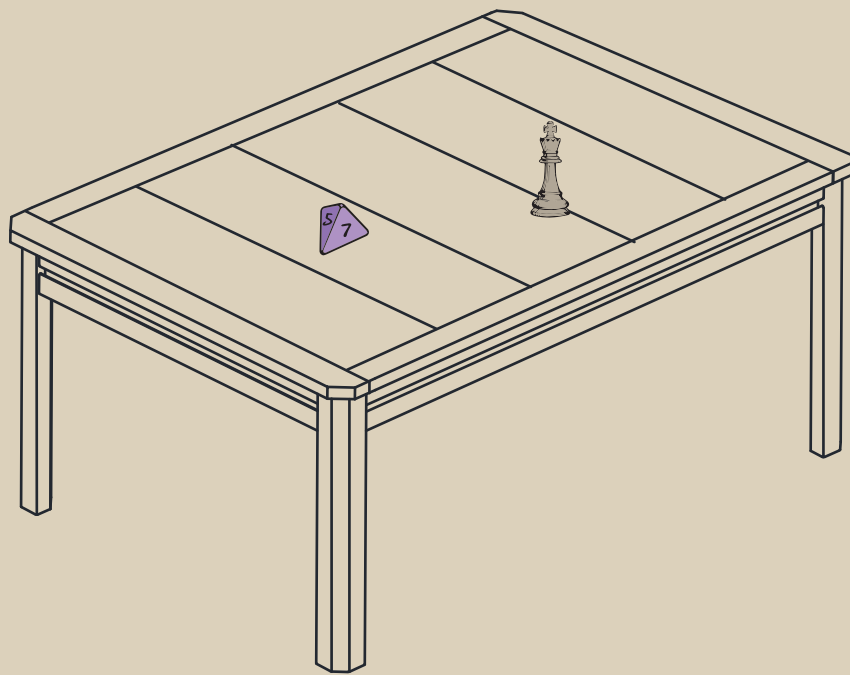

Standard Kingswood(4×6'): The Royal Game Table

INSTRUCTION MANUAL

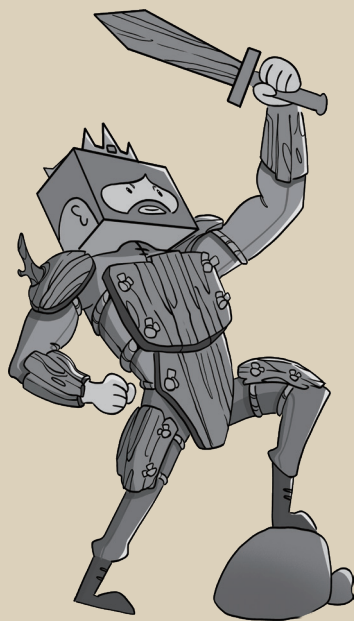

NOBLE MAJESTY!

You've been waiting a while for your Project Kingswood table to arrive thank you for your patience,
Noble One!

Today is a glorious day! Project Kingswood stands ready to serve you in every future gaming session - it just needs a little assembly first...but we're here to help!

Our deepest thanks to every gracious Majesty who has supported and pre-ordered! Over the years, you've helped us take BoxKing Gaming from a flicker of imagination to a small but stalwart gaming company: from project Ironside BoxThrone board game shelves, and LAX RAX, and now Project Kingwood - and many more in the future!

Feel free to tag us on Instagram, YouTube or Facebook once you've built your table! We'll share, retweet, or reply to your post!

Instagram: @BoxKing Gaming

YouTube: @BoxKing Gaming

Facebook: www.facebook.com/BoxKingGaming



You can also see other curious creations at
www.boxkinggaming.com

Onwards, your Majesty - your table awaits!

Humbly yours,

Dan Blacklock and the team at BoxKing Gaming



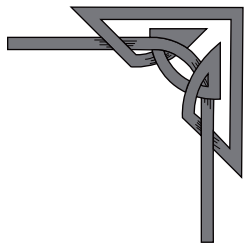
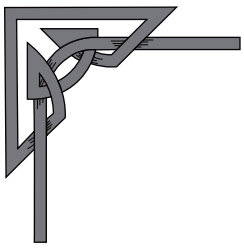

SAFETY WARNINGS

- After assembly, tighten all screws and bolts every 4-6 months.
- This table contains SMALL PARTS - Keep children under 3years old AWAY from the table at all times!
- The maximum weight the gaming surface can support 70 kg (154 lbs).
- The maximum total weight the entire table can safely support 150 kg (331 lbs).
- To clean wood, use a slightly damp cloth.
- If the Kingswood package arrives damaged or incomplete, please contact customer service.
- Keep wood surfaces dry, and dry immediately if wet.

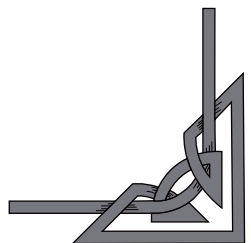
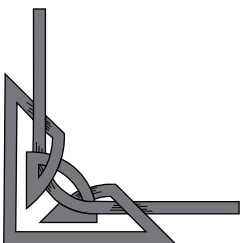

Step 1: Prepare the Components

Required components:

1. wooden cover panels x5
2. Table long frame x2
3. Table short frame x2
4. Table legs x4
5. Bottom panels x5
6. Screws x34
7. Cam bolt x8
8. Cam lock x8
9. Wrench x1
10. Phillips screwdriver x1
11. Wood dowel x16
12. Metal rod x1

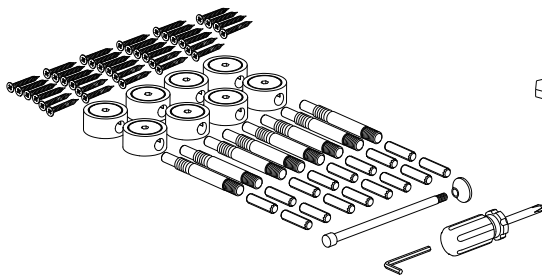
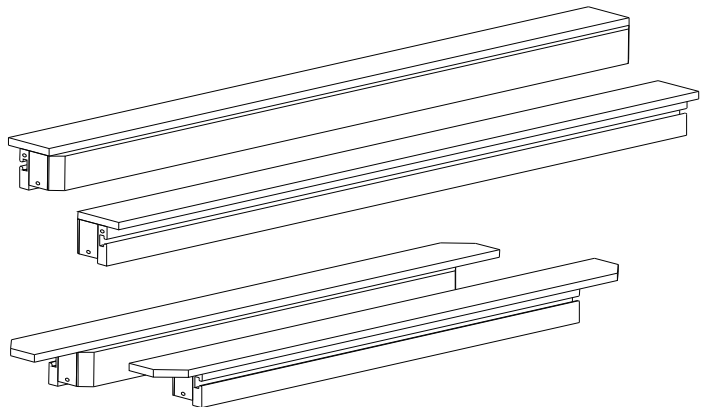
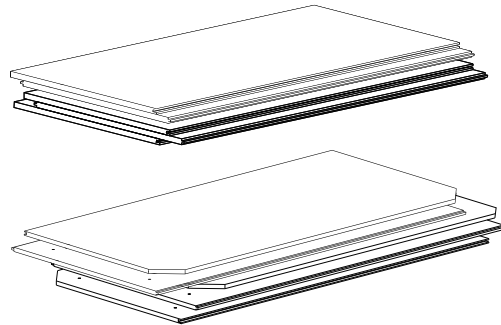
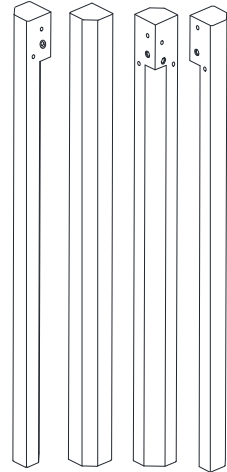

Step 2: Pre-Install The Cam Bolt And Wood Dowel

- Take one table leg and insert 1 cam bolt into the holes on the leg with screwdriver, insert 1 wood dowel into the wood dowel holes on the leg. Use the Screwdriver to tighten the cam bolt.

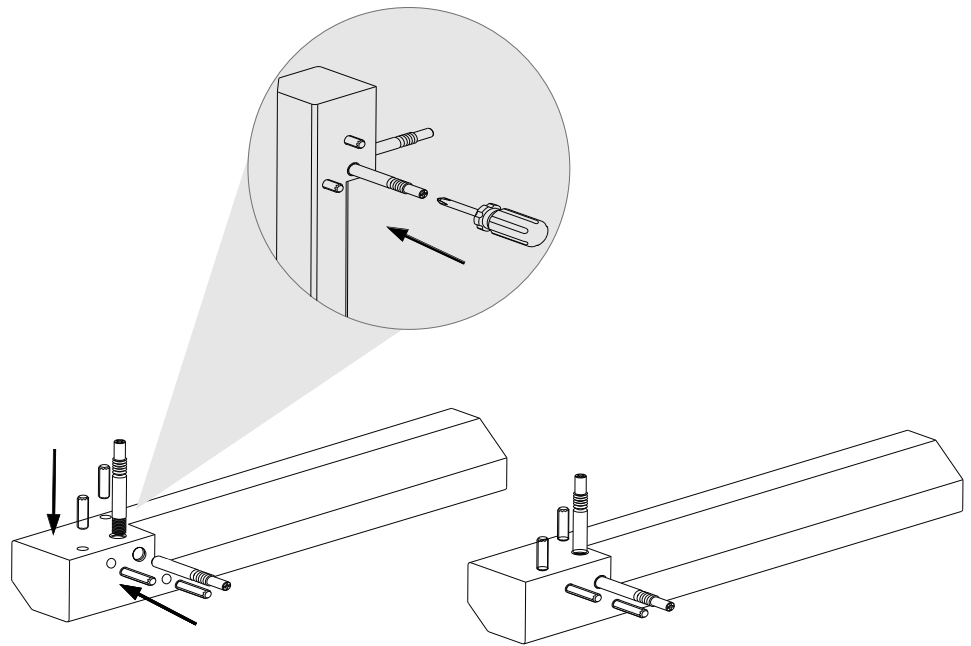

- Follow the same process to install the remaining 7 cam bolts and wood dowels into the other table legs.

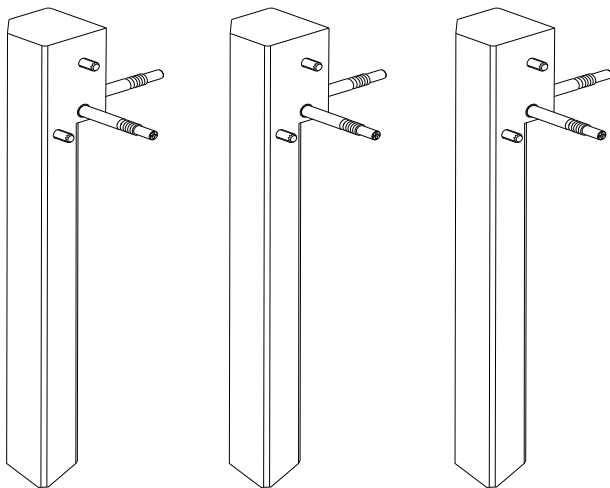

Step 3: Attach the Table Legs and Tighten the Cam locks

- Use the wrench to fully tighten the two cam locks in the hole, ensuring the leg is firmly fixed.

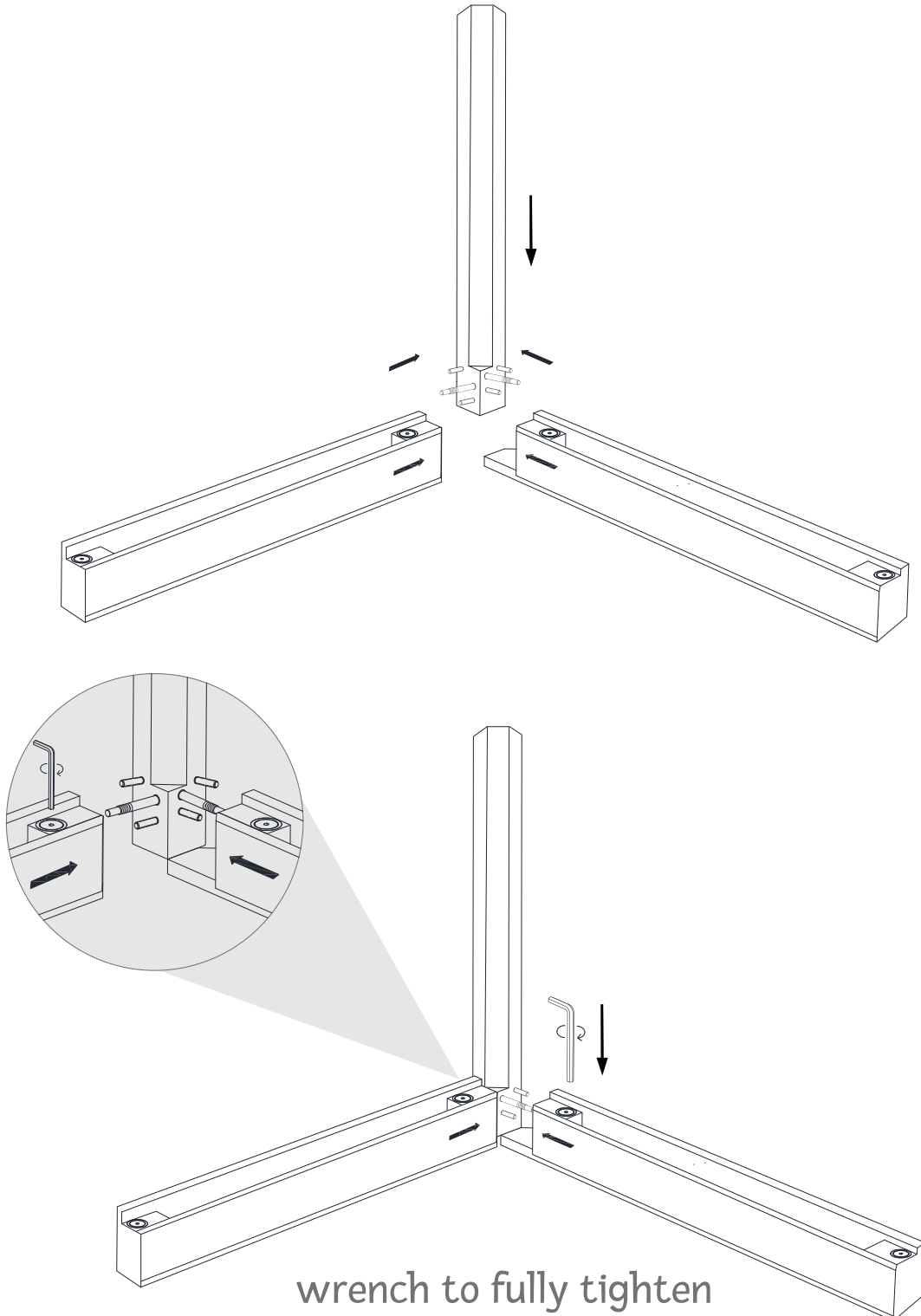

Step 4: Wrench To Tighten

- Turn the tabletop upside down and place it flat on the ground.

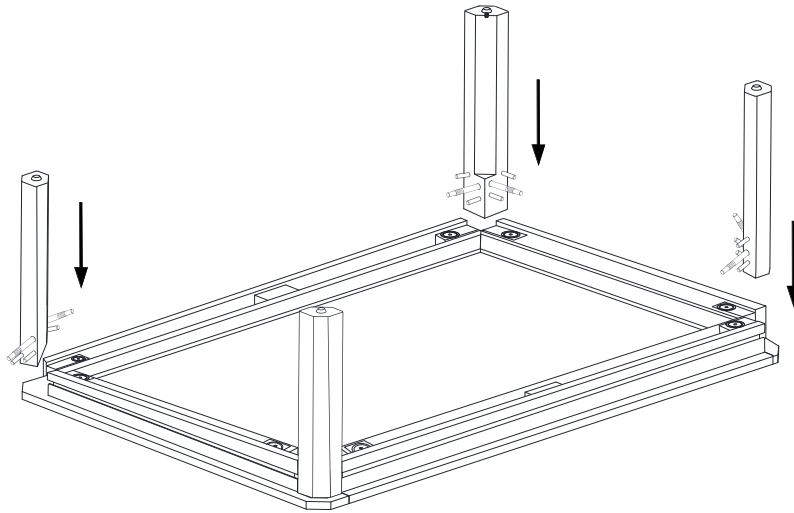

- Repeat the same process for the other three table legs, aligning them with the triangular holes on the tabletop, use the wrench to tighten all cam lock securely.

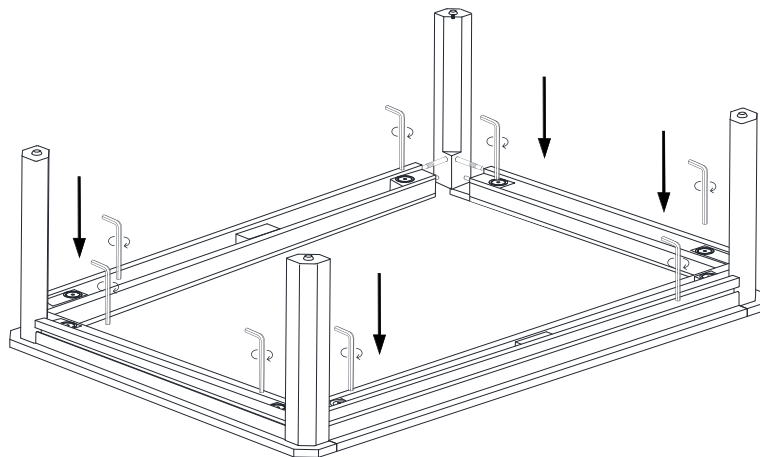



Step 5: Install The Bottom Panels

- Place the 5 bottom panels into the recessed slots on the table bottom.

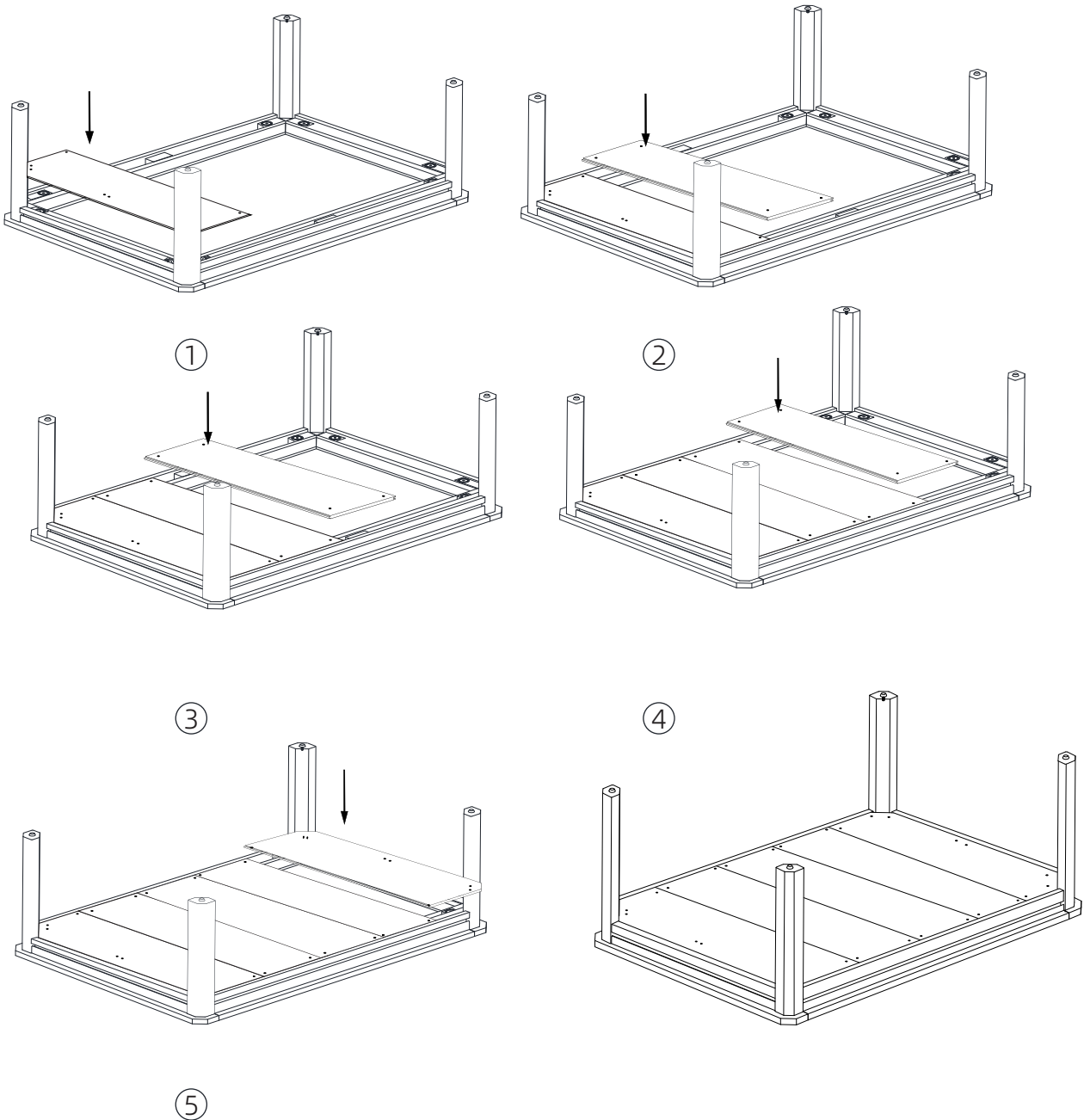



Step 6: Tighten The Screw

- Use the screwdriver to tighten the screw.

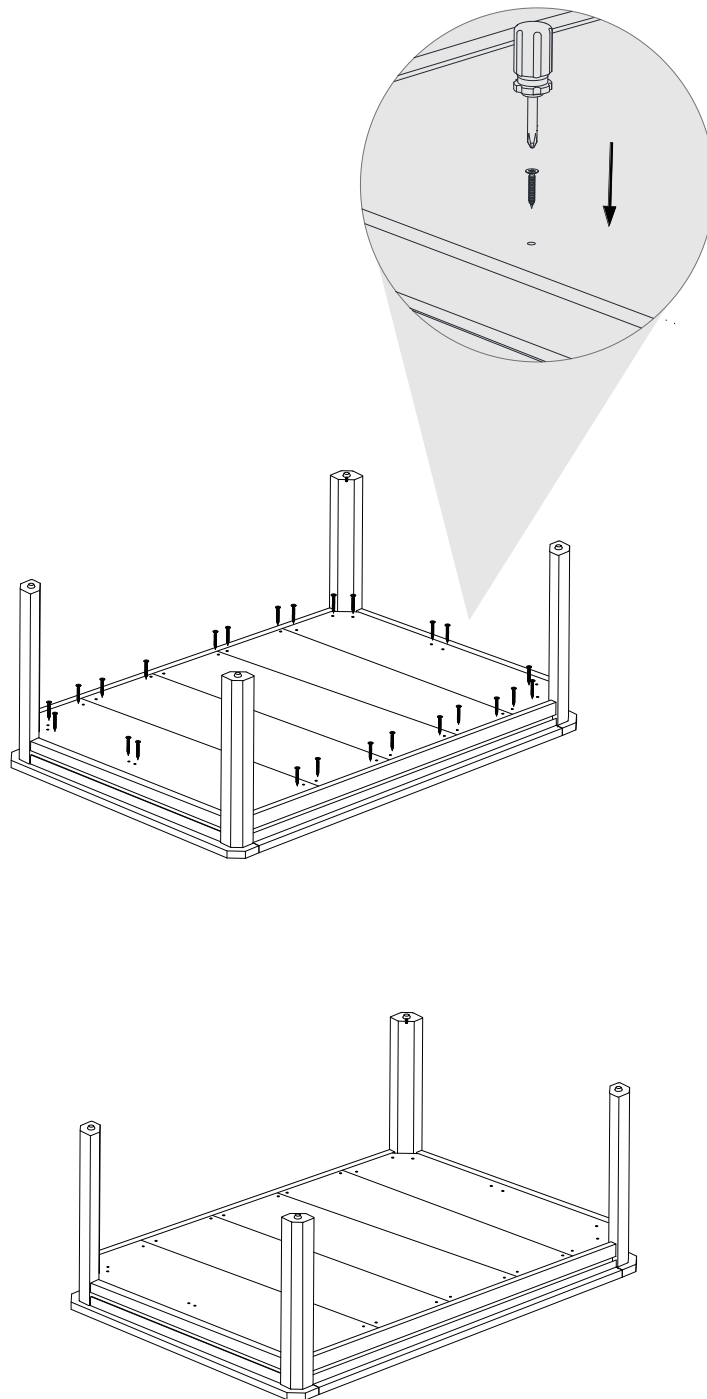



Step 7: Flip The Table

- Once all the panels are secured, flip the table upright so the tabletop is facing up.

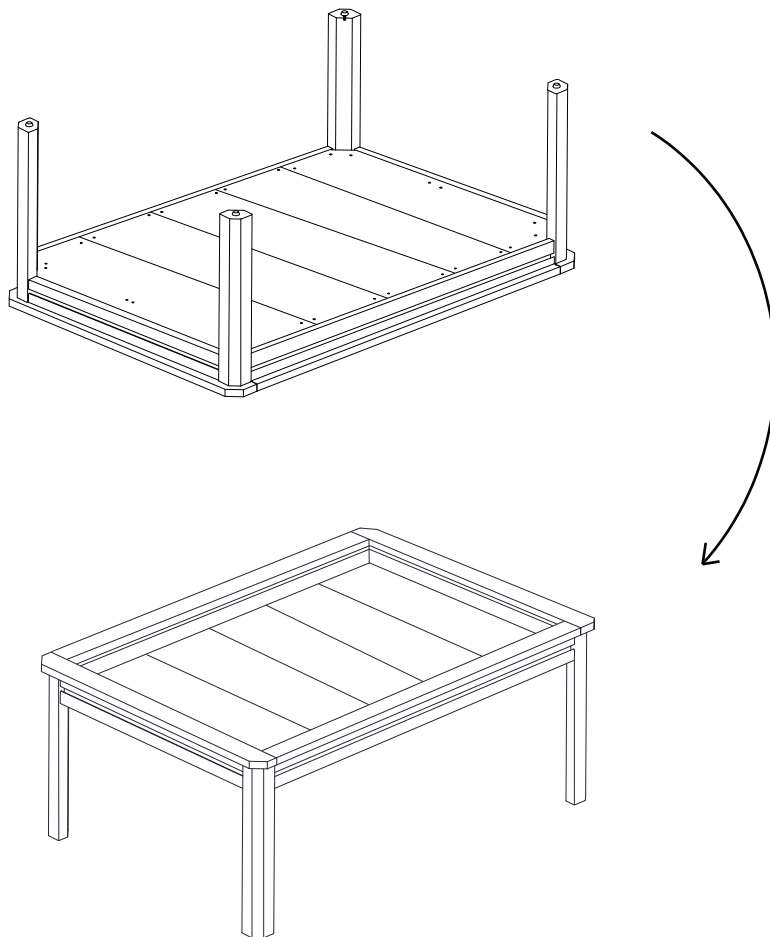

Step 8: Insert The Metal Rod

- Insert the metal rod into the designated hole on one side of the tabletop, from underneath the table, tighten the nut on the metal rod's thread to secure it.

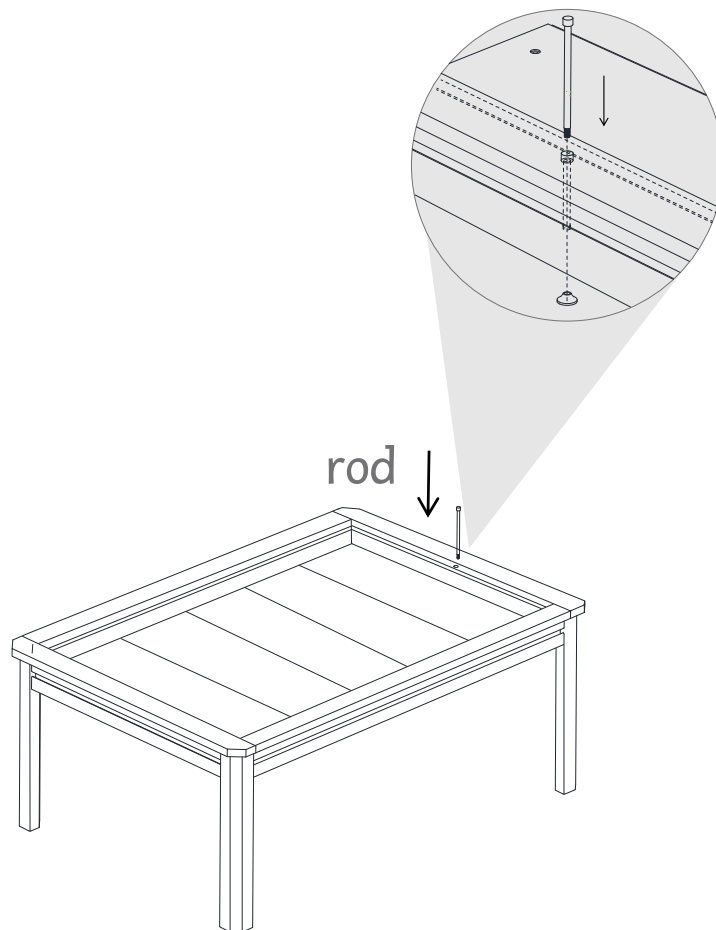



Step 9: Complete the Assembly

- Place five wooden cover panels into the recessed slots on the tabletop, assembly is now complete!

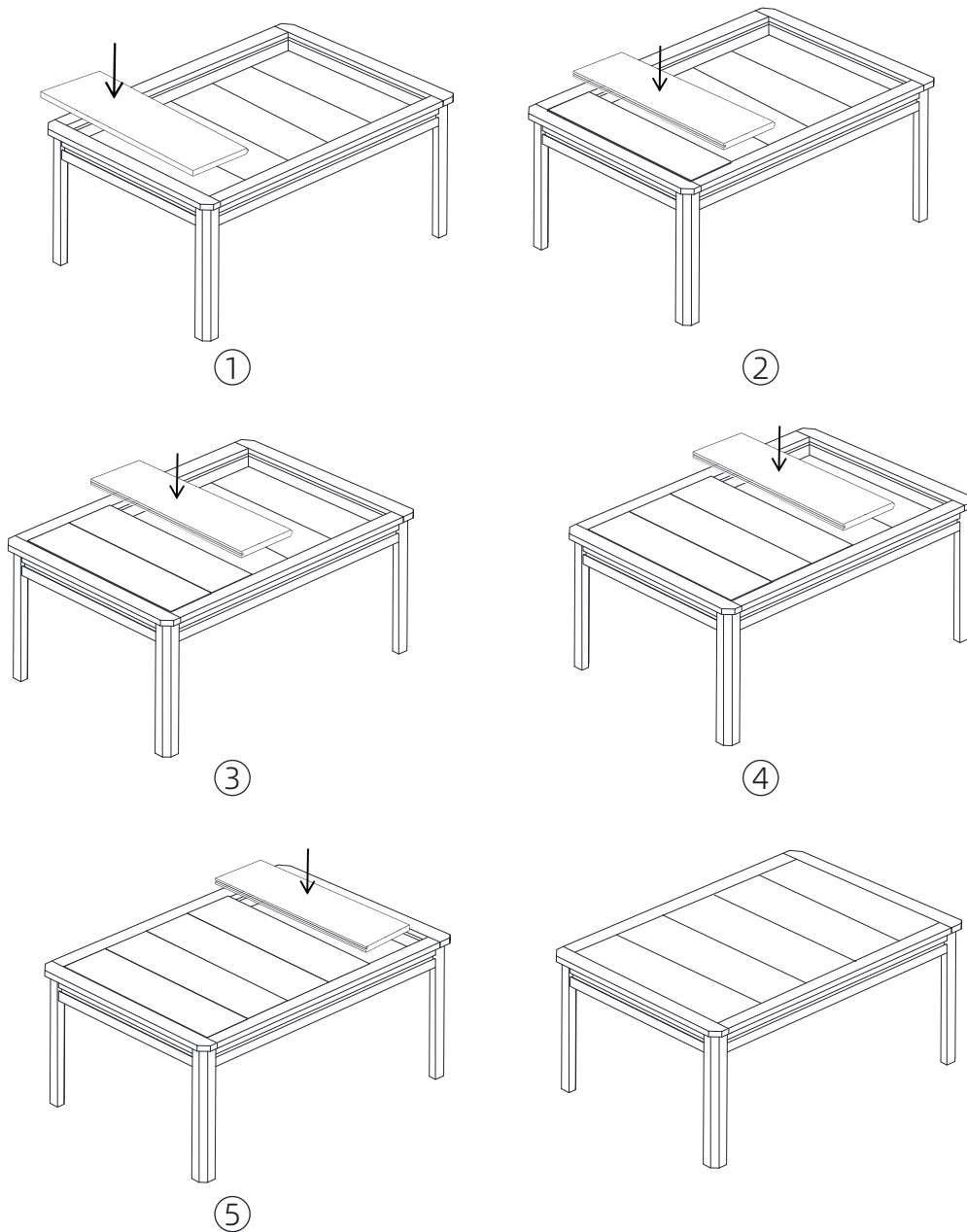

If you have any questions, please contact us at
support@boxkinggaming.com.